

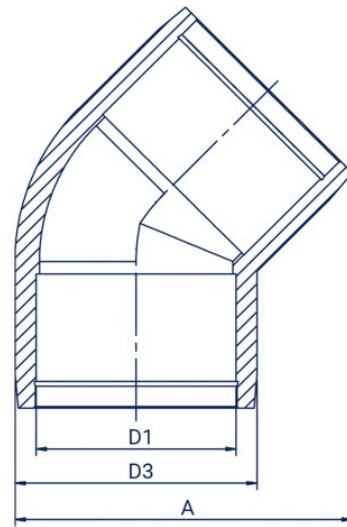

- material: PE 100-RC
- application: water and gas
- 16 bar water, 10 bar gas
- MRS - 10 MPa
- centre stop



Code	D1 (mm)	D3 (mm)	A (mm)	Quantity per parcel
KE4502011	20	35	65	200
KE4502511	25	35	65	180
KE4503211	32	42	72	160
KE4504011	40	53	84	90
KE4505011	50	67	97	60
KE4506311	63	81	114	35
KE4507511	75	93	140	20
KE4509011	90	112	160	12
KE4511011	110	135	185	8
KE4512511	125	151	208	10
KE4514011	140	170	225	8
KE4516011	160	195	253	5

