

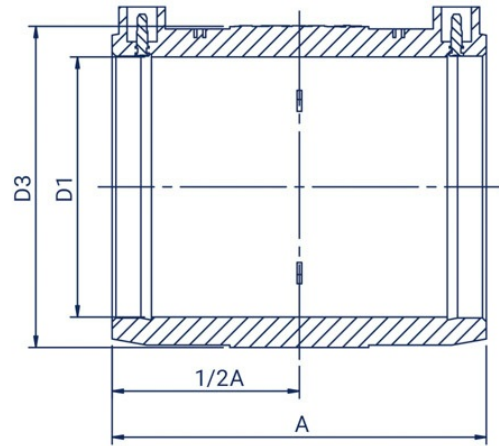

- material: PE 100-RC
- application: water and gas
- 10 bar water, 5 bar gas
- MRS - 10 MPa
- removable centre stop
- no centre stop in 315-630 mm diameters



Code	D1 (mm)	D3 (mm)	A (mm)	Quantity per parcel
ME35517	355	412	296	2
ME40017	400	462	303	1
ME45017	450	512	320	1
ME50017	500	575	377	1
ME56017	560	630	390	1
ME63017	630	714	396	1

